

# Thermafoil® Live-Loaded Valve Stem Packing Data Sheet

Please complete the 2 steps below and email or fax to [egc-ent.com](mailto:egc-ent.com). This information is **REQUIRED** for accurate design, quotation and manufacture of an EGC graphite pressure seal for your application. Incomplete, inaccurate or missing information will result in a delay or inability to design, quote or manufacture the required pressure seal.

## Step 1: Customer & Valve Data

Company: \_\_\_\_\_ Contact Name: \_\_\_\_\_  
 Plant: \_\_\_\_\_ Email: \_\_\_\_\_  
 Valve Location: \_\_\_\_\_ Valve Manufacturer: \_\_\_\_\_  
 Valve Size: \_\_\_\_\_ Valve Type: \_\_\_\_\_ Valve Figure No.: \_\_\_\_\_  
 Phone: \_\_\_\_\_ Valve Pressure Class: \_\_\_\_\_ Qty. Required: \_\_\_\_\_

**Step 2:** Provide dimensions below using the stuffing box illustrations for reference.  
**ACCURATE & COMPLETE** data is essential to ensure proper fit & function of a new Pressure Seal.

- 1) What is the Valve Pressure Class \_\_\_\_\_
- 2) Operating Temperature \_\_\_\_\_ °F
- 3) A) Stem OD: \_\_\_\_\_ in.
- 4) B) Stuffing Box ID: \_\_\_\_\_ in.
- 5) C) Stuffing Box Depth: \_\_\_\_\_ in.
- 6) D) Glad Follower Length: \_\_\_\_\_ in.
- 7) E) Glad Follower OD: \_\_\_\_\_ in.
- 8) F) Glad Follower ID: \_\_\_\_\_ in.
- 9) G) Fastener Size (stud diameter) \_\_\_\_\_ in.
- 10) H) Axial Clearance (A.C.) \_\_\_\_\_ in.
- 11) J) Radial Clearance (R.C.) \_\_\_\_\_ in.
- 12) (K) Stud Diameter \_\_\_\_\_
- 13) Number of Fasteners \_\_\_\_\_
- 14) Stem Motion \_\_\_\_\_

(Rotating or Rising or Rotating/Rising)

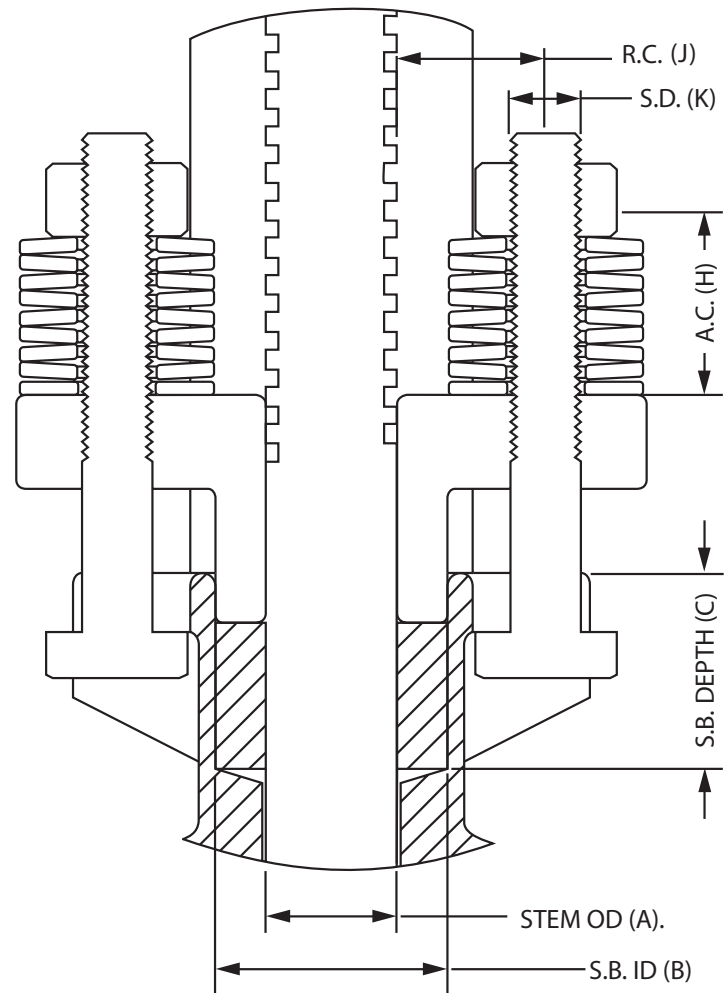

**Please fax or email completed form to EGC for prompt quotation. Thank you.**